

MICRO  
PIEZO™

EPSON  
EXCEED YOUR VISION

Colour Inkjet Printer

Epson WorkForce Pro WP-4011

## SPECIFICATIONS

<div>Epson WorkForce Pro WP-4011</div> <div>Weight: 10.9 kg</div> <div></div> <div>#Cost-per-print (CPP) was calculated with Epson published yield (refer to *5 below) based on the ISO/IEC 24711/24712 standard and estimated ink cartridge price in the market. Ink cartridge price may vary depending on stores and Epson does not guarantee the CPP.</div> <div>*1 Print speed (Pages Per Minute) is calculated when printed on A4 plain paper in the fastest mode, 10 x 15 cm photo print speed when printed on Epson Premium Glossy Photo Paper. Print speed may vary depending on system configuration, print mode, document complexity, software, type of paper used and connectivity. Print speed does not include processing time on host computer.</div> <div></div> <div>*2 When printed on Epson Premium Glossy Photo Paper.</div> <div>*3 Supported Paper for each Market should be confirmed by referring to following "EPSON SPECIALTY MEDIA" Chapter.</div> <div>*4 Via custom setting. Otherwise 3 mm top, left, right, bottom.</div> <div>*5 In accordance with ISO 24711/24712. Actual yields will vary considerably for reasons including images printed, print settings, temperature and humidity. Yields may be lower when printing infrequently or predominantly with one ink colour. A variable amount of ink remains in the cartridges after the "replace cartridge" signal. Part of the ink from the first cartridges is used for priming the printer. Ink is used for both printing and print head maintenance. All inks are used for both black and colour printing.</div> <div></div> <div>EPSON and EXCEED YOUR VISION are registered trademarks of Seiko Epson Corporation.</div> <div>All other product names and other company names used herein are for identification purposes only and are the trademarks or registered trademarks of their respective owners.</div> <div>EPSON disclaims any and all rights in those marks. Scan/Print samples shown herein are simulations. Specifications are subject to change without notice.</div>	<div>MODEL</div> <div>WP-4011 Print</div> <div>PRODUCT CODE</div> <div>C11CB27411</div> <div>PRINTER TYPE</div> <div>PRINTING METHOD NOZZLE CONFIGURATION PRINT DIRECTION</div> <div>On-demand ink jet (piezoelectric) 152x4 nozzles Black, 152 nozzles, each colour (Cyan, Magenta, Yellow) Bi-directional printing, Uni-directional printing</div> <div>PRINT FUNCTION</div> <div>MAXIMUM RESOLUTION MINIMUM DROPLET VOLUME PRINT SPEED *1 MAX BLACK DRAFT TEXT MEMO (A4) MAX COLOUR DRAFT TEXT MEMO (A4) ISO 24734, A4 - SIMPLEX ISO 24734, A4 - DUPLEX DUPLEX PRINTING</div> <div>4800 x 1200 dpi (with Variable-Sized Droplet Technology) 3 pl Approx. 26 ppm (Draft) Approx. 24 ppm (Draft) Approx. 16/11 ppm (Bk/Ci) Approx. 9.2/7.1 ppm (Bk/Ci) Yes</div> <div>PRINTER INTERFACE</div> <div>STANDARD ETHERNET</div> <div>USB 2.0 Hi-Speed 10Base-T/100Base-TX</div> <div>PAPER HANDLING</div> <div>PAPER FEED METHOD NUMBER OF PAPER TRAYS PAPER HOLD CAPACITY</div> <div>INPUT CAPACITY OUTPUT CAPACITY</div> <div>Friction feed 2 (standard), 3 (optional) Front Cassette: 250 sheets, A4 Plain (80gsm) Rear ASF: 80 sheets, A4 Plain (80gsm), 20 sheets Premium Glossy Photo Paper 150 sheets, A4 Plain (Default Text)</div> <div>PAPER SIZE</div> <div>Front Cassette: A4, A5, B5, Letter (8 1/2" x 11"), Legal (8 1/2" x 14") Additional Cassette: A4, A5, B5, Letter (8 1/2" x 11"), Legal (8 1/2" x 14") Rear ASF: A4, A5, A6, B5, 10x15cm (4" x 6"), 13 x 18 cm (5" x 7"), 9x13cm (3.5 x 5"), Letter (8 1/2" x 11"), Legal (8 1/2" x 14"), Half Letter (5 1/2" x 8 1/2"), 13 x 20cm (5" x 8"), 20 x 25cm (8" x 10"), 16:9 wide size, 100 x 148 mm, Envelopes: #10 (4 1/8" x 9 1/2"), DL (110 x 220 mm), C6 (114 x 162 mm), C4 (229 x 324 mm)</div> <div>MAXIMUM PAPER SIZE PRINT MARGIN NOISE LEVEL</div> <div>LwAd LpAm</div> <div>8.5" x 44" (only Rear ASF) 3 mm top, left, right, bottom (via custom setting) 6.2 B(A) 48 dB(A)</div> <div>ELECTRICAL SPECIFICATIONS</div> <div>RATED VOLTAGE RATED FREQUENCY POWER CONSUMPTION PRINTING READY MODE SLEEP MODE POWER OFF MODE</div> <div>AC 100-240V (Rated voltage will vary depending on area) 50-60 Hz Approx. 22 W Approx. 5.0 W Approx. 2.2 W Approx. 0.3 W</div> <div>PRINTER SOFTWARE ON CD-ROM</div> <div>OPERATING SYSTEM COMPATIBILITY</div> <div>Windows XP/XP Professional x64 Edition/Vista/7/ *Windows Server 2008R2, 2008, 2003 Mac OS X 10.4.11, 10.5x, 10.6x Yes *Only printing is supported under Windows Server OS. Scanning and bundled applications are not supported.</div> <div>ONLINE GUIDE</div> <div></div>	<div>EPSON GENUINE INK CARTRIDGES</div> <div>677 INK SERIES BLACK 678 INK SERIES BLACK CYAN MAGENTA YELLOW</div>	<div>PAGE YIELD *5</div> <div>3,400 pages 2,400 pages 1,200 pages composite yield 1,200 pages composite yield 1,200 pages composite yield</div>	<div>ORDER CODE</div> <div>C13T677190 C13T678190 C13T678290 C13T678390 C13T678490</div>	<div>MAINTENANCE BOX</div>	<div>Up to 50,000 pages</div>	<div>C13T671000</div>
<div>EPSON GENUINE INK CARTRIDGES</div> <div>677 INK SERIES BLACK 678 INK SERIES BLACK CYAN MAGENTA YELLOW</div>	<div>PAGE YIELD *5</div> <div>3,400 pages 2,400 pages 1,200 pages composite yield 1,200 pages composite yield 1,200 pages composite yield</div>	<div>ORDER CODE</div> <div>C13T677190 C13T678190 C13T678290 C13T678390 C13T678490</div>					
<div>MAINTENANCE BOX</div>	<div>Up to 50,000 pages</div>	<div>C13T671000</div>					

### Epson Singapore Pte Ltd

1 HarbourFront Place #03-02  
HarbourFront Tower One  
Singapore 098633  
Tel: (65) 6586-5500 Fax: (65) 6271-9755

### Epson Customer Care Centre

108 Pasir Panjang Road  
#04-08 Golden Agri Plaza  
Singapore 118535  
Epson Helpdesk @ (65) 6586-3111

Sales Enquiries  
**6586 3111**

[www.epson.com.sg](http://www.epson.com.sg)



Information correct at time of printing.

Printed in October 2011

COLOUR INKJET PRINTER  
Epson WorkForce Pro WP-4011

EPSON  
EXCEED YOUR VISION

## Double-Up On Your Printing Productivity

With the World's Fastest Auto Two-Sided Printing



MICRO  
PIEZO™



Epson WorkForce Pro WP-4011

The Epson WorkForce Pro WP-4011 printer delivers superb print quality in double-quick time with its highly durable Epson Micro Piezo™ print head and built-in networking capabilities for your office and home.

#### • World's Fastest Auto Two-Sided Printing

Enjoy class-leading auto duplex print speeds of 9.2/7.1 ppm (Bk/Ci) that also lowers paper consumption and gives better readability than printing multiple pages on a sheet.

#### • Save Up to 50% in Running Cost

High-capacity ink cartridges yield 3,400 pages at just S\$0.02\* per page for monochrome prints to help you save up to 50% on running costs compared to laser printers.

#### • Low Energy Consumption

Energy Star certified for assured efficiency in energy consumption, up to 70% lower compared to laser printers.



Epson 677 and 678 high capacity ink cartridges yield up to 3,400 pages at just S\$0.02\* per page for monochrome prints. Save up to 50% of running costs compared to laser printers.\*

\*For details, please refer to specifications





**MICRO  
PIEZO™**

Epson WorkForce Pro WP-4011

## World's Fastest Auto Two-Sided Printing

Achieve peak productivity with fast initial print out time and a class leading auto two-sided print speed of 9.2 and 7.1 ppm for black-and-white and colour respectively, producing crisp and clear documents efficiently.

Single-sided printouts are achieved at a print speed of 16 and 11 ppm for black-and-white and colour respectively.

Fastest in its class: printing black text in default, two-sided mode, in accordance with ISO/IEC 24734. Compared to inkjet and all-in-ones priced at US\$399 (incl. tax) or less, based on manufacturers' rated ISO speeds or independent testing. Comparisons are based on the information available at the time of publication and are for illustrative purpose only.



## Save up to 50% in Running Cost

The Epson WorkForce Pro WP-4011 maximises your savings with high capacity ink cartridges that yield up to 3,400 pages in black-and-white, at just S\$0.02\* per page for monochrome prints. Compared to conventional laser printers, you save up to 50% in running costs.



## Low Energy Consumption



Operating cost is further reduced with the Energy Star compliant WorkForce Pro WP-4011, designed to lower energy consumption by as much as 70% compared to conventional laser printers.

Results based on Epson internal testing conducted using US-equivalent 120V models.

## Excellent Media Handling

Reduce the hassle and time spent on replenishing paper with the optional 250-sheet paper tray that increases total capacity to 580 sheets. Enjoy greater flexibility with both 250-sheet front paper cassette and 80-sheet rear paper feeder for a wide range of print media, including plain paper, labels, envelopes and photo media.



## Ready to Connect



The Epson WorkForce Pro WP-4011 is equipped with Hi-Speed USB 2.0 as well as Ethernet connectivity, making it ideally suited for office and SOHO environments. Our easy setup solution makes it a breeze to share your WorkForce Pro printer with PCs, laptops and even smartphones.

### Epson Net Config

- Easy network installation and settings for office environments

### Epson iPrint 2.0

- Print photos, web pages and documents wirelessly from Apple® and Android® mobile devices when printer is connected to a WiFi router
- Scan, save and share files
- Supports online cloud services such as Box.net, Dropbox and Evernote



## Impressive Business Printing Quality

Presenting your best is easy with re-engineered print head and DURABrite™ Ultra Inks, an all-purpose ink that promises brilliant printouts for reports, charts and photos that last. Superior printing quality is now possible with this revolutionary smudge, fade and water resistant ink. What's more, its instant drying formula makes it ideal for double-sided printing.



## Reliable and Easy to Maintain

The Epson WorkForce Pro WP-4011 is designed to support a high monthly duty cycle of up to 20,000 pages. For added convenience, WP-401 comes with an easily replaceable maintenance box so that you do not need to bring the printer for servicing when the ink pad is full.

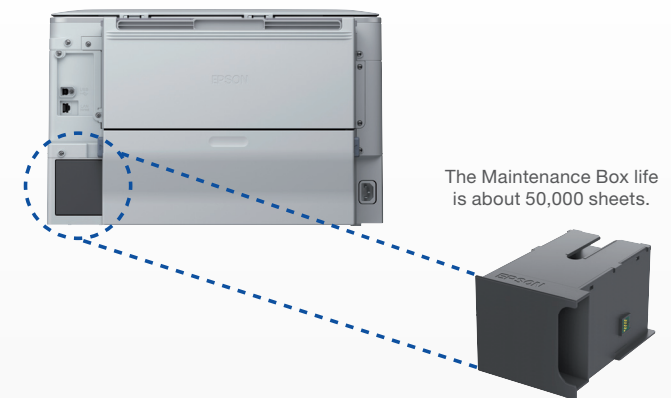

## Partners in Perfection



### Epson DURABrite™ Ultra Inks

Designed specifically to work with your Epson printer to deliver high quality and long lasting prints. Choose from standard capacity and high capacity cartridges to suit your printing needs.

- Epson 678 Inks (standard capacity)
- Epson 677 Inks (high capacity)

For page yield, please refer to specifications.



### Epson K100/K200/K300 Monochrome Inkjet Printers

Epson K-Series monochrome solutions gets more done at a lower running cost of S\$0.015 per page. With laser-like speed and quality, the K-Series produces crisp black-and-white documents at 16ppm and blazes along at 37ppm for draft quality printing.